

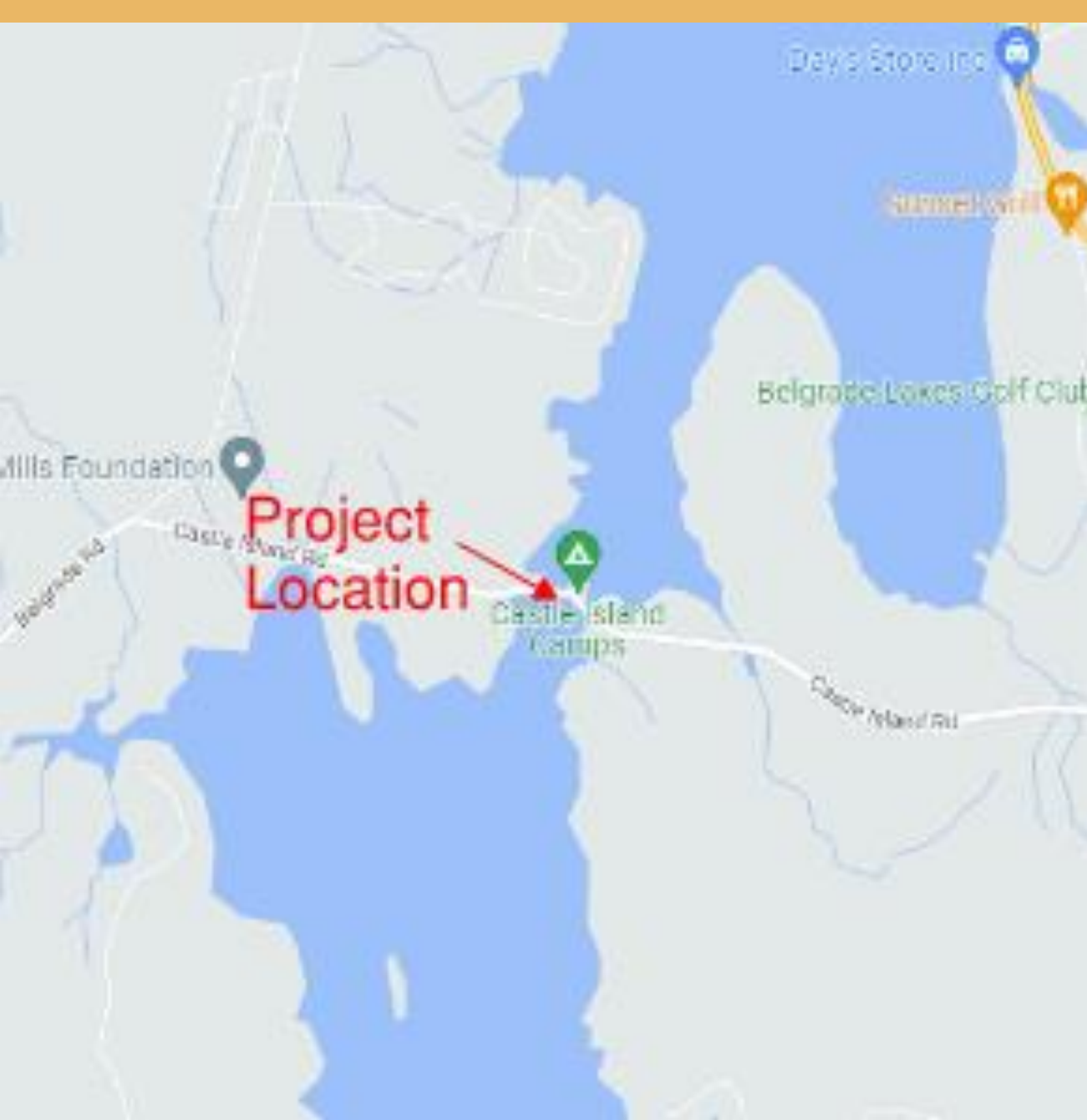

ROME, NARROWS WEST BRIDGE NO 5912

Tony Beaulieu, P.E.



PROJECT LOCATION

- Castle Island Road
- Approx 2.2 miles west of Route 27
- Spans over Long Pond

EXISTING CONDITIONS

- Constructed in 1985
- Two span steel bolted pipe arch culverts
- Originally scheduled for replacement in 2024
- Recent sink hole, road closure and temporary structure
- Project will require detour, not enough room for temporary bridge or staged construction

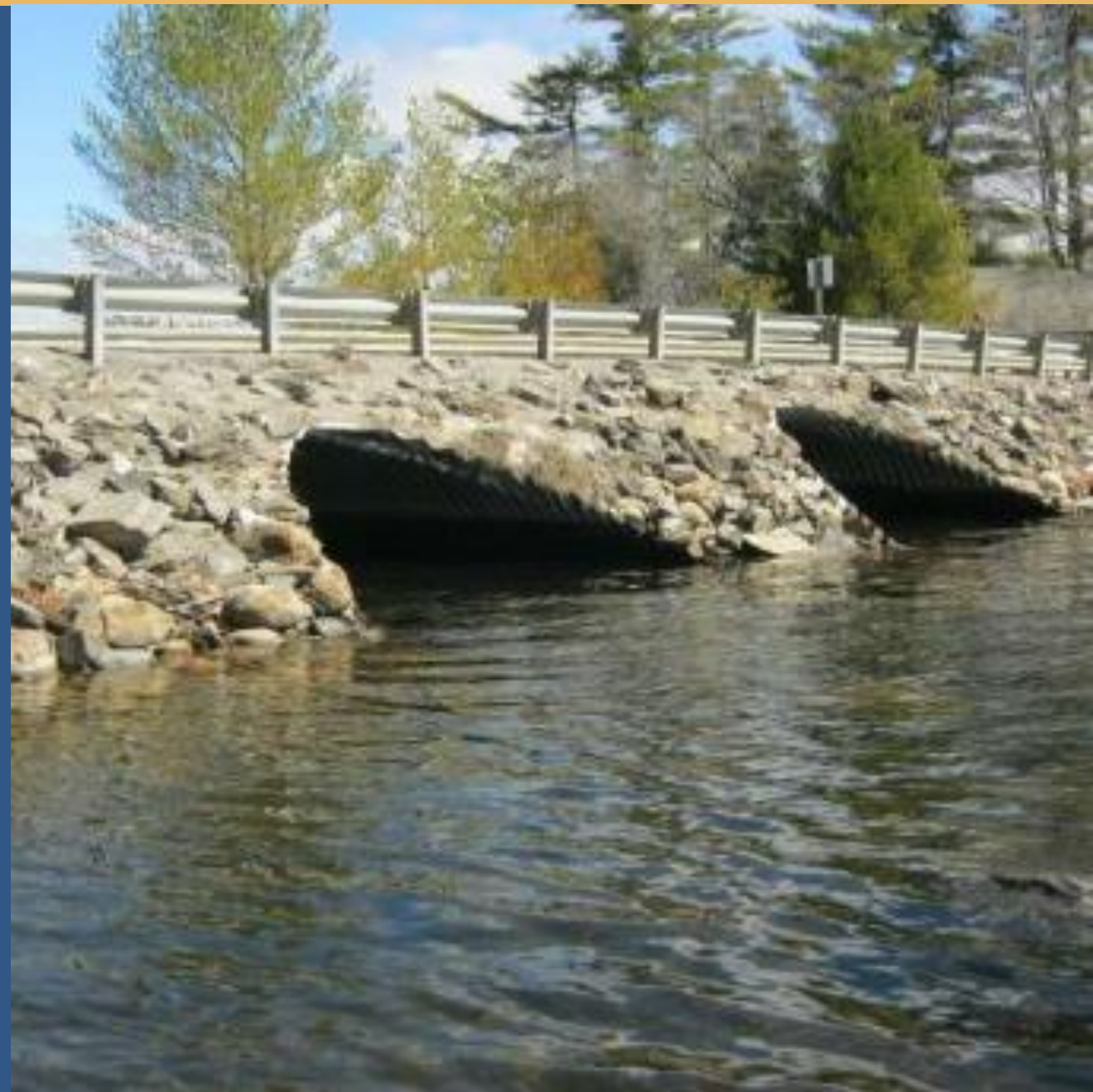

BRIDGE REPLACEMENT

- 56' Single Span Bridge
- 32" NEXT F Beam superstructure with concrete abutments
- 2 - 11 ft travel lanes with 1' shoulders
- Concrete curbing, railings and guardrail
- Maintaining existing hydraulic opening

BRIDGE REPLACEMENT

- Project to bid beginning of October
- In water work window September 10-April 30
- Anticipated completion before Memorial Day weekend



MAINTENANCE OF TRAFFIC

- Road closure- detour
- State Route- 34 miles, 45 minutes
- Local Route- 14 miles, 20 minutes

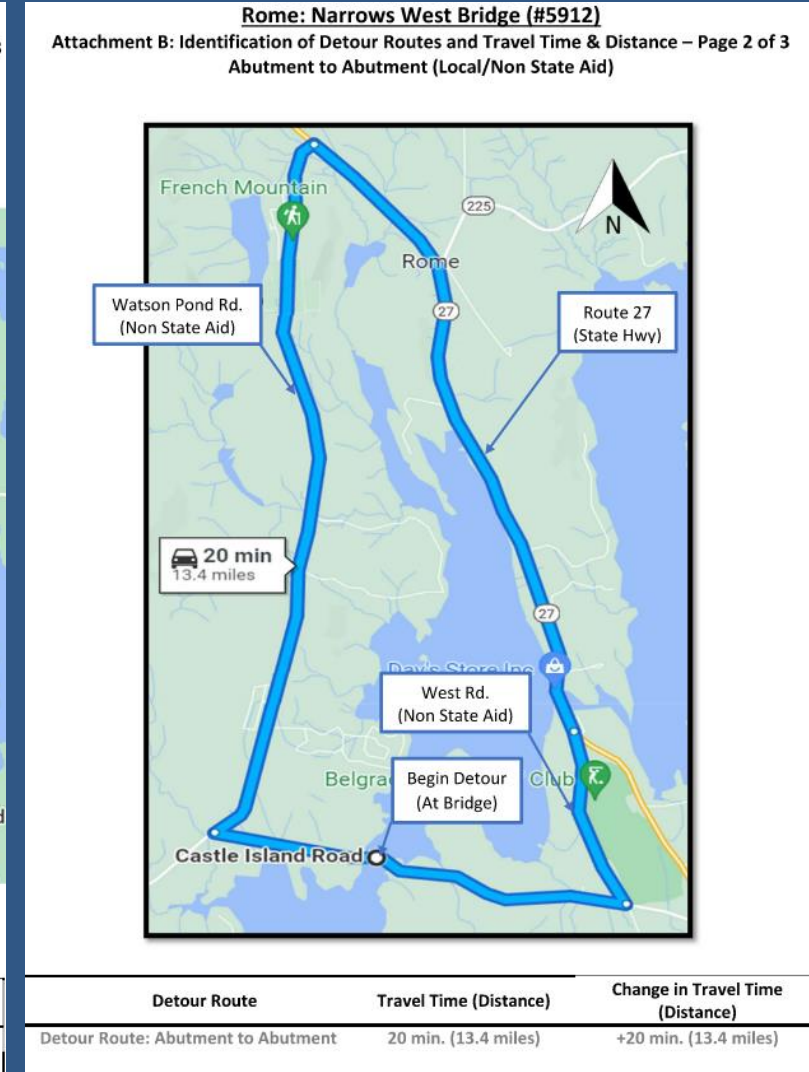
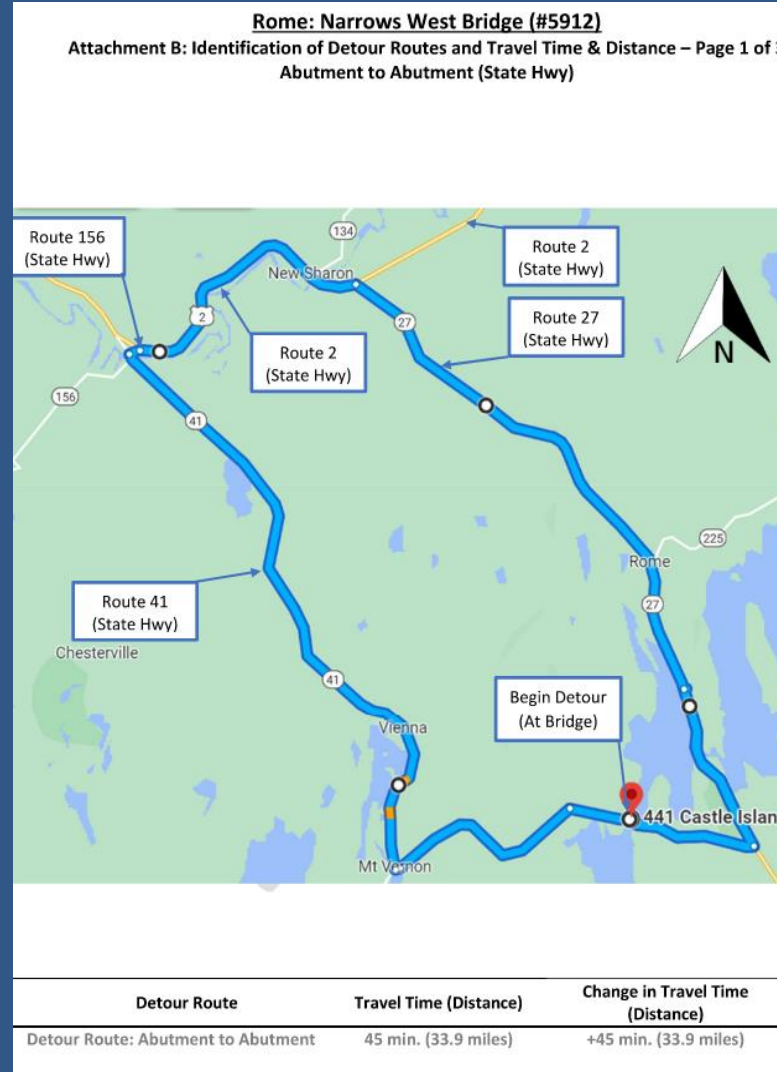

MAINTENANCE OF TRAFFIC

- Winter Maintenance
- School buses
- Castle Island camps

NEXT STEPS/SCHEDULE

- Final Design- 98% plans to be developed for bid
- Advertise October 2022
- Construction November 2022-May 2023

PRELIMINARY PLANS- PLAN VIEW

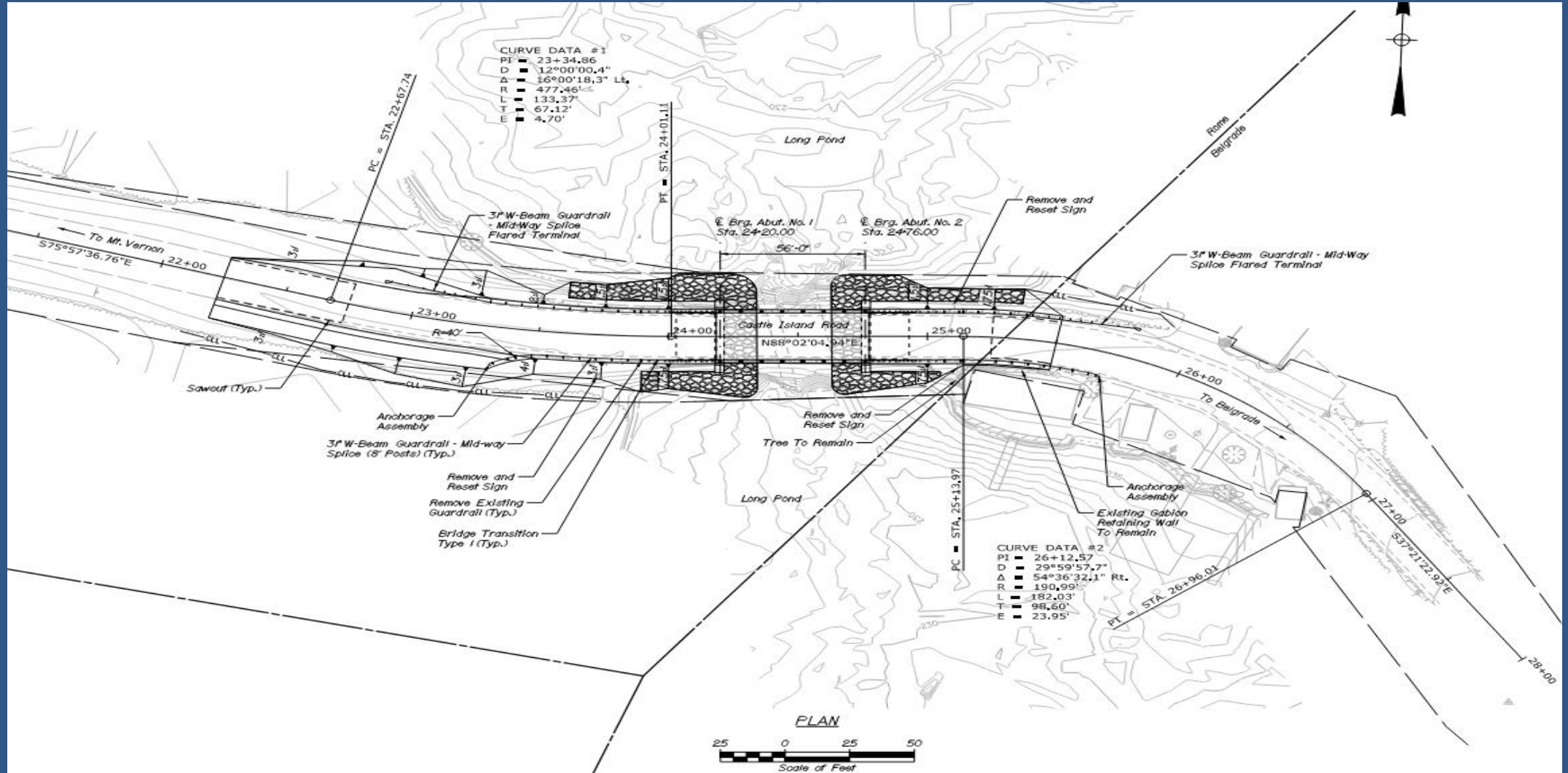

PRELIMINARY PLANS- PROFILE

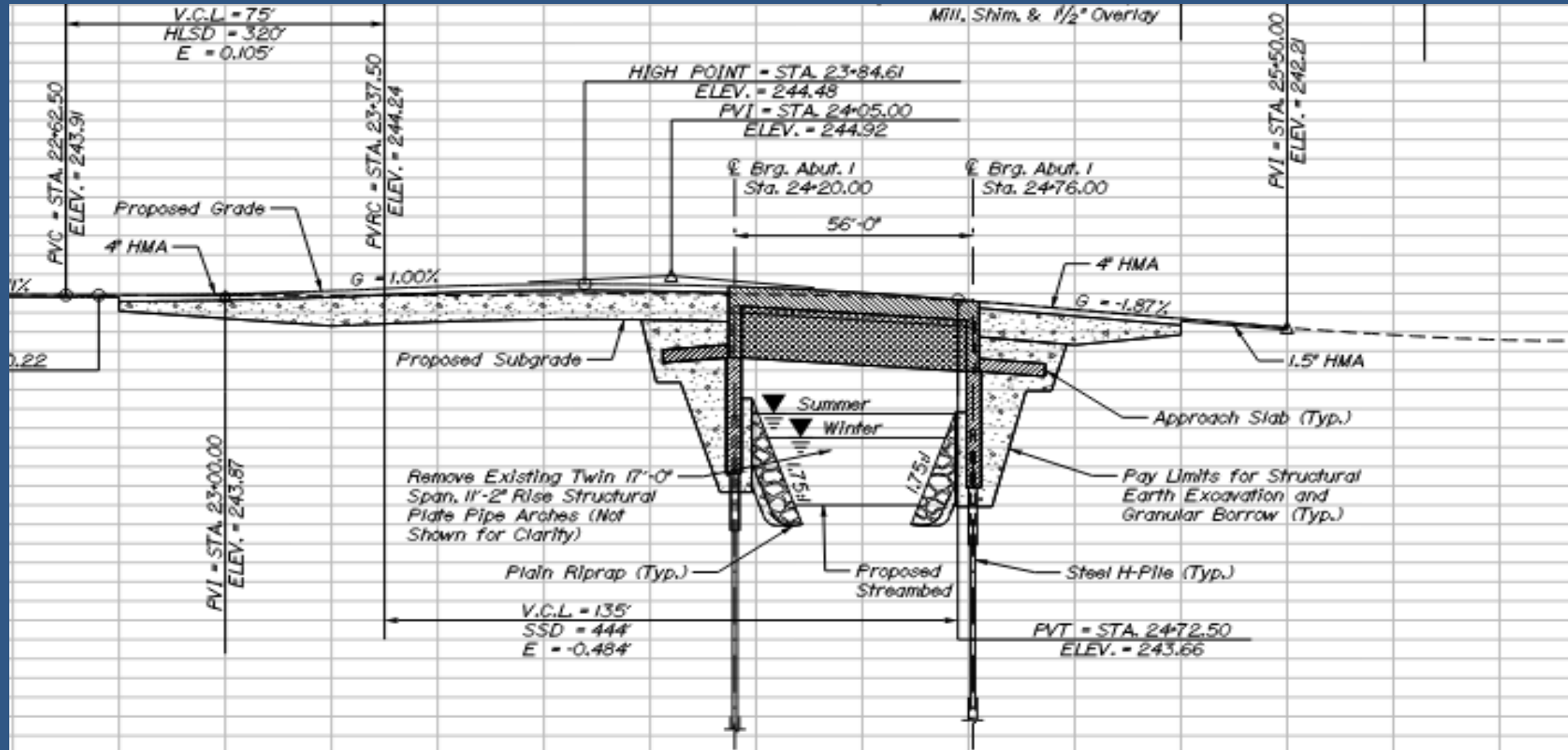

PRELIMINARY PLANS- TYPICAL SECTIONS

