

Shoreland  
 Certified Contractor  
 Number # \_\_\_\_\_  
 Non Shoreland

*\$19.44*  
*725.00* / *44.44*

**Town of Belgrade, Maine**  
**APPLICATION FOR PERMIT**

990 Augusta Road Belgrade Me 04917  
 207-495-2258

Application # \_\_\_\_\_  
 Map# 18 Lot# 009  
 Permit# \_\_\_\_\_

Date Logged 2/6/24 Date Rec'd by PB/CEO 1/14/24 \$ \_\_\_\_\_ Fee Paid Receipt# \_\_\_\_\_

<p>1. Applicant:          Name <u>Timothy Cahill</u>          Mailing Addr <u>51 Grenwold rd., Quincy</u>          State/Zip <u>MA 02169</u> Phone# <u>617-828-8587</u></p>	<p>2. Owner (if other than applicant):          Name _____          Mailing Address _____          State/Zip _____ Phone# _____</p>
---	---

3. Specific location of property 23 South Sandy Cove Rd., Belgrade Map# 18 Lot# 009  
 Name of Lake/Pond/Stream (if applicable) Long Pond

4. Current use of property (check all that apply)

Residential/Recreational;  Individual Private Campsite;  Commercial;  Industrial;  Other

5. Proposed construction or change in use: build a new 18x18 Shed

6. Existing sewage disposal system type and capacity: 1000 gallon concrete septic with 180 gallon per day design flow  
 Present number of bedrooms 2; Bedrooms to be added under this application 0  
 When did you purchase the property within Shoreland Zone? January 3, 2014 (month/year) If after 11/6/18, attach copy of septic system inspection report documenting it is not malfunctioning.

7. Total lot area 36,800 s.f.; Lot area within the Shoreland Zone \_\_\_\_\_

8. Square footage of unvegetated surface within shoreland zone including all structures, driveways, parking, walkways and patios. 2500 s.f. approximate

9. What is the total area of cleared openings of woody vegetation (Sqft) 0

10. Total number of structures on the lot - 3 (replacing shed). A site plan to-scale MUST accompany this application and be prepared in accordance with the requirements on the attached Instruction Sheet (Item #10 on the Instruction

Sheet). All required

Present Structure Square Footage \_\_\_\_\_

Proposed Structure Square Footage 324 sq. ft.

\*Required only for structures within Shoreland Zone

I/We have obtained and understand the requirements of all Town of Belgrade Ordinance which apply to the proposed construction or change of use. The undersigned applies for a permit to build, alter or improve existing structure(s) or grounds as stated above on this application and portrayed on the attachments. The information provided is true and correct.

Signature: Tina Cahill Signature: Timothy P. Cahill

**There may be additional Federal, State or local permits required depending on the nature of the project.**

**TOWN USE ONLY**

DECISION: APPROVE DISAPPROVED

Conditions \_\_\_\_\_  
 \_\_\_\_\_  
 \_\_\_\_\_

Date: \_\_\_\_\_ PB \_\_\_\_\_ CEO \_\_\_\_\_

Signatures: \_\_\_\_\_  
 \_\_\_\_\_  
 \_\_\_\_\_

**Jason Trembly Carpentry, LLC**

Exterior or interior projects or repairs for your home

Fully Insured



PO Box 754  
Oakland, Maine 04963

**207-465-9562**

Materials Supplied By  
**Hammond**  
Lumber Company

**Customer:**

Tim and Tina Cahill  
Sandy Cove Road  
Belgrade, ME

**Date:**

September 9, 2023

**Construction of New 18' X 18' Shed**

- Install new 18" concrete pads as needed
- Construct floor and wall framing
- Install Smartside Brand T111-style sheathing/siding
- Construct 5/12 pitch gable-style roof
- Install a standing seam metal roof (in forest green color)
- Insulate the walls and roof
- Install interior walls and ceiling
- Install windows and door

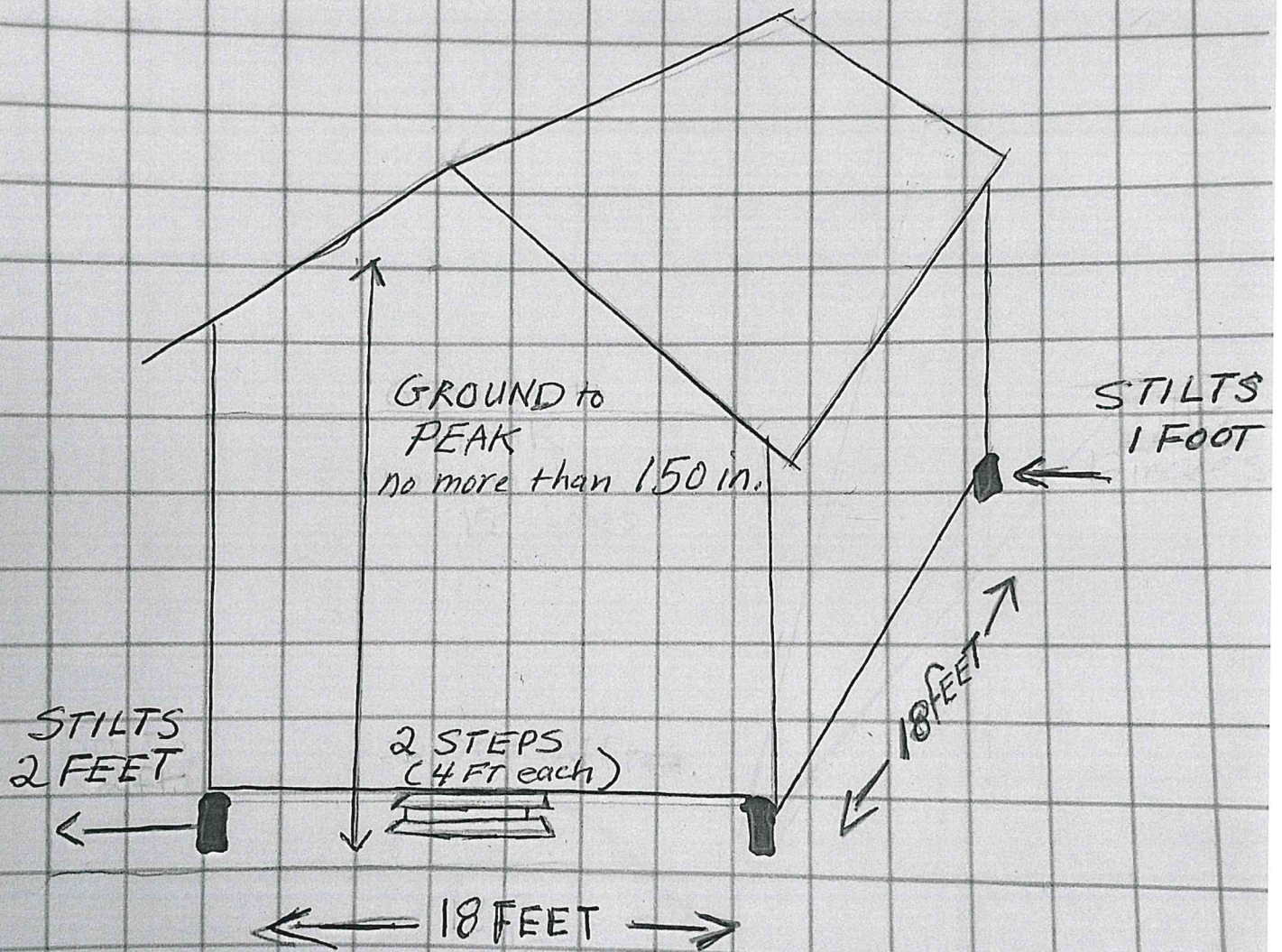

# Camp Campari

Key:

□ = 5 sq. ft.

160'

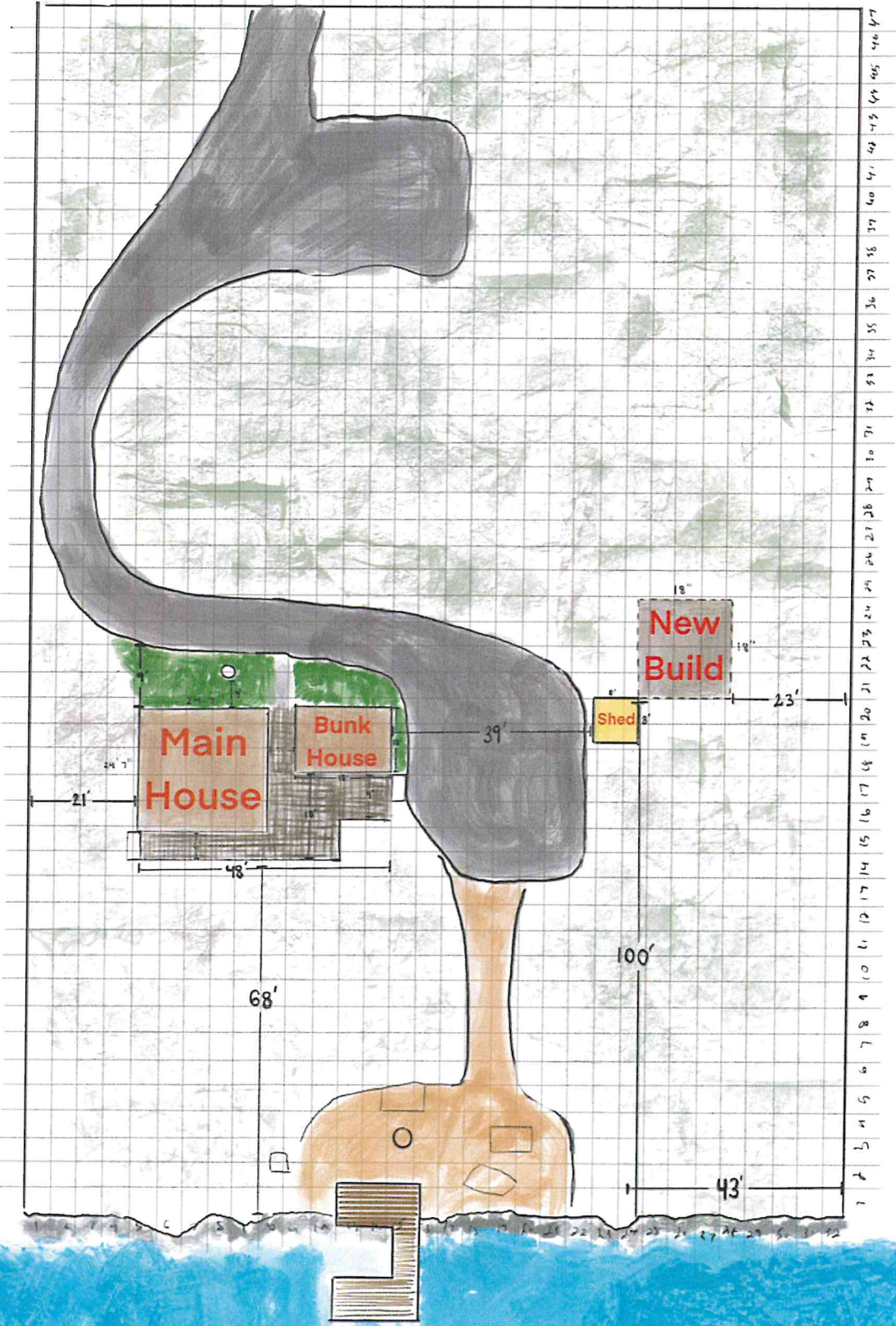

235'





10:55



July 4, 2017  
9:57 AM

Edit





Photos Map

Ask an agent

